

Bra Quilt Downloadable

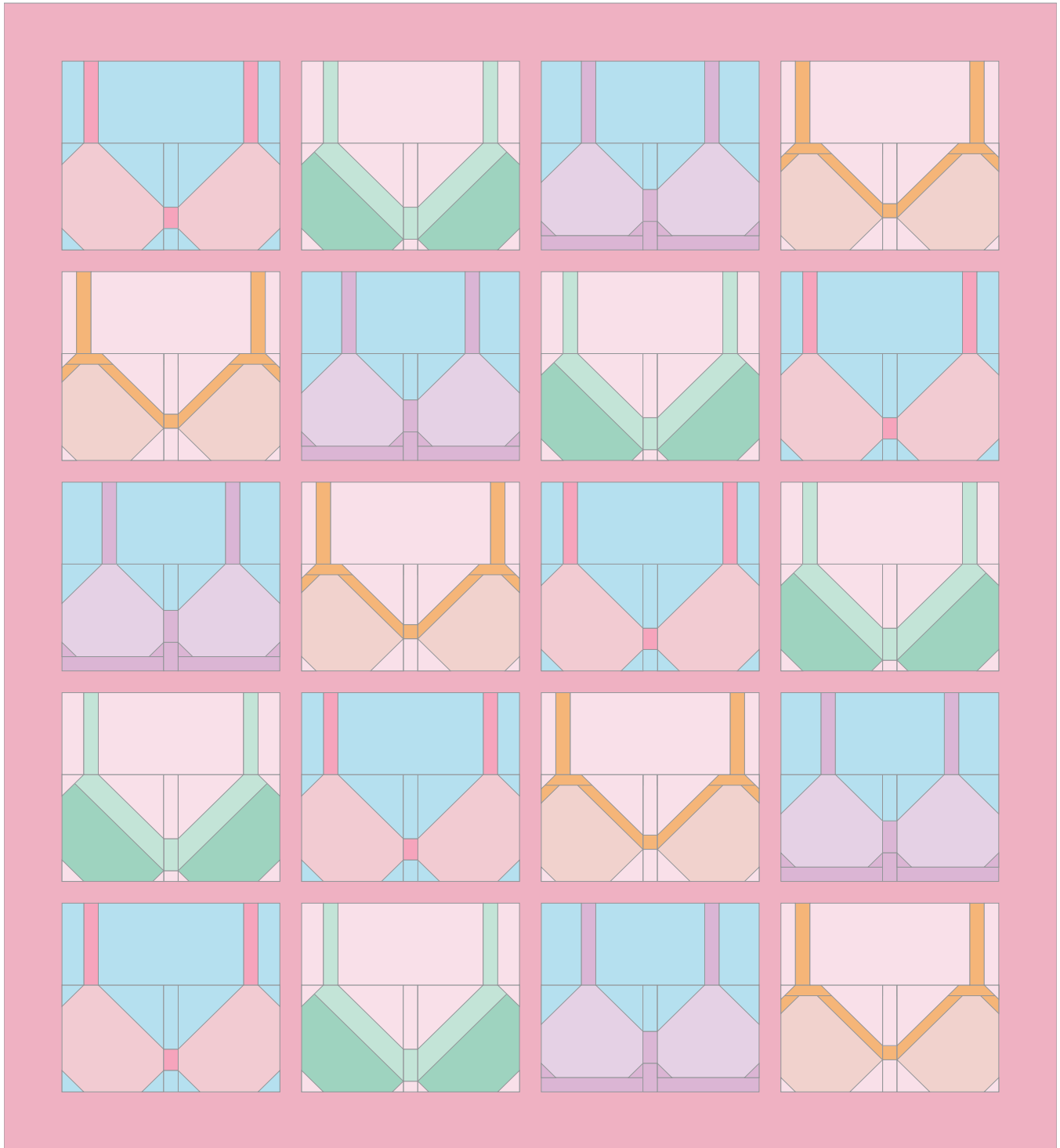

Bra Style A

Materials for 5 Bras

- Background Color (Blue)
1 ½ yards
- Strap Color (Dark Pink)
1 yard
- Cup Color (Light Pink)
4 ½ yards

Notes

- Use a ¼" seam allowance

Cut Your Fabric

- Background Color (Blue) fabric
10 squares 5"
30 squares 2"
10 strips 2" x 6.25"
5 strips 1½" x 5"
5 strips 1½" x 2
5 rectangles 10½" x 6¼"
- Strap Color (Dark Pink) fabric
10 strips 1½" x 6¼"
5 strips 1½" x 2
- Cup Color (Light Pink) fabric
10 squares 7½" x 8"

Piece Your Bra

- 1 For the cups you will need 2 7½" x 8" of the light pink fabric, 2 5" squares and 6 2" squares of the blue fabric.

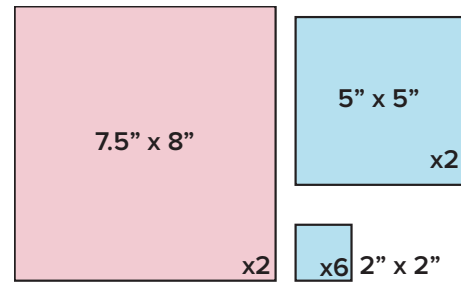

- 2 Place the 8" side as the height and then pin 5" squares on the top inside corner of the pink squares and sew to create half square triangles.

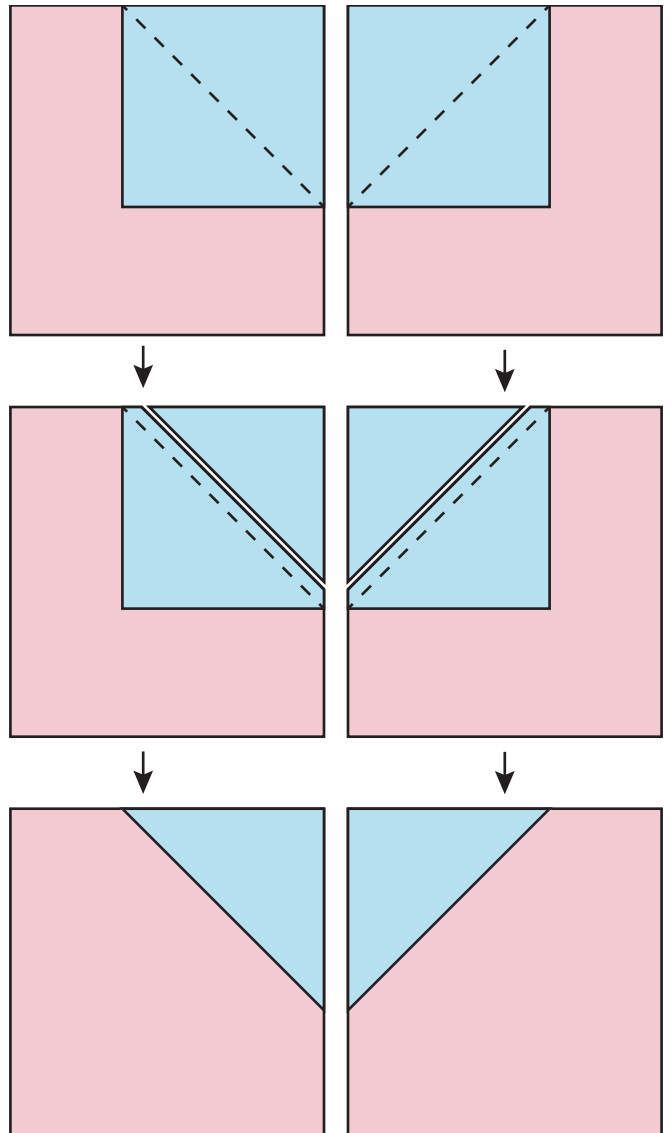

3 Repeat the process for all the other corners of the cups making half square triangles with the 6 2" x 2" squares.

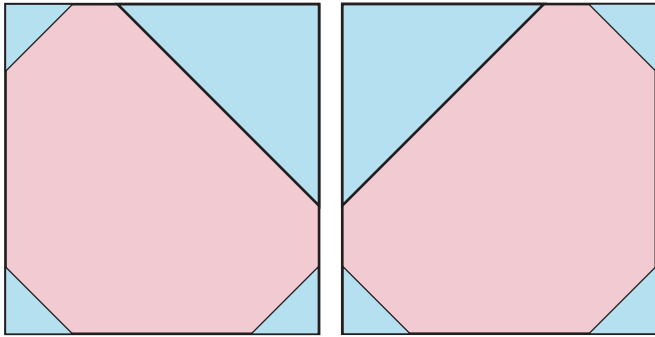

4 To make the strap part gather 2 2" x 6.25" and 10.5" x 6.25" blue fabric strips and 2 1.5" x 6.25" dark pink strips for the strap part of the bra.

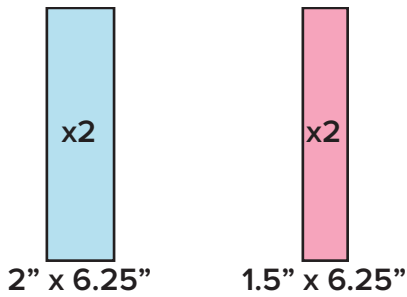

5 Strip piece together going in the pattern of small blue, pink, big blue, pink, small blue



6 Grab the pieces for the middle piece which are the 1.5" x 5" blue strip, 1.5" x 2" blue strip, and the 1.5" x 2" dark pink strip.

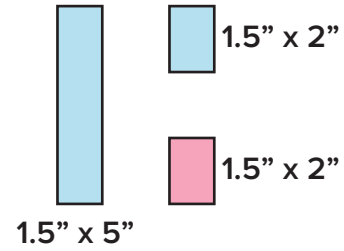

7 Strip piece the fabric making a vertical 1.5" strip of fabric.



8 For the last part piece together all pieces starting with putting together the cups with the middle piece. And after that is sewn piece together the strap part to the cups.

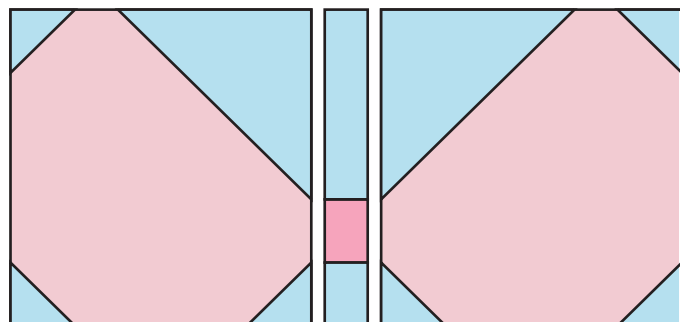
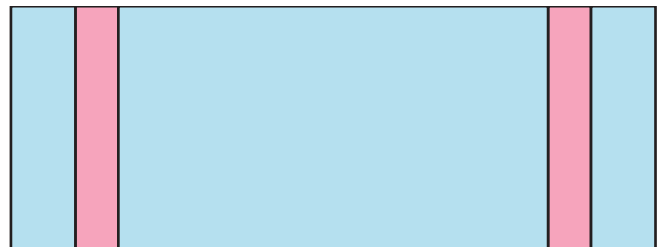

9 Repeat this process 4 other times so you have created 5 Style A bras in total.

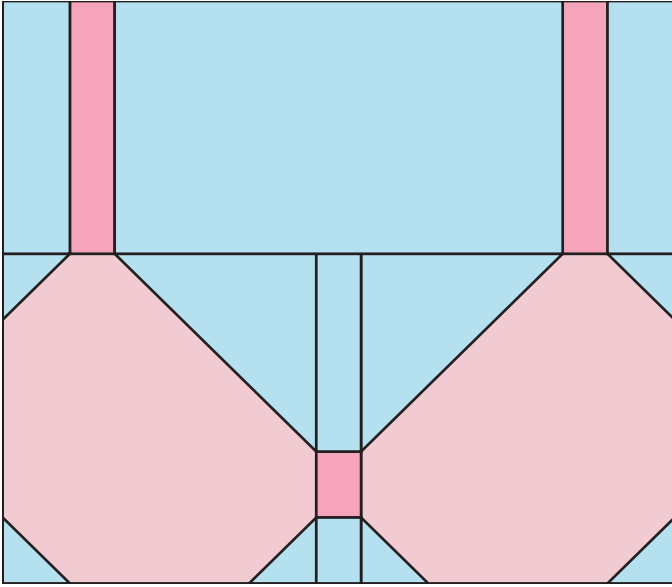

(The other 3 style of bras will be added to this downloadable on a later date)